

HANDY

LOUDSPEAKERS HARDWARE

Wall Bracket for MIA Series & NIMBO-14

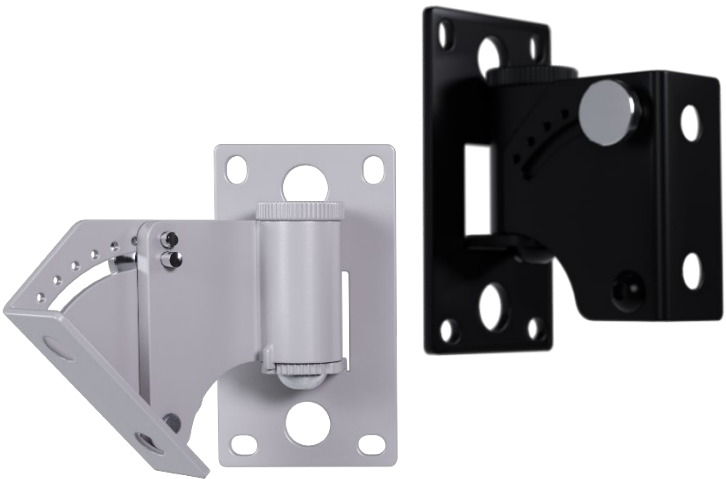

PRODUCT OVERVIEW

HANDY is a wall bracket compatible with the MIA Series and NIMBO-14 loudspeakers. It is incredibly versatile and intelligent with swivel and tilt adjustment, made of aluminium & stainless steel. Available in black and white.

KEY FEATURES

- Made out of aluminium & stainless-steel
- Pan and tilt bracket for wall-mount
- Available in black (RAL 9005) and white (RAL 9016).

APPLICATIONS

- MIA Series loudspeakers
- NIMBO-14 loudspeaker



TECHNICAL SPECIFICATIONS

HANDY

PHYSICAL		
Installation options	Surface (wall mount)	
Enclosure	Aluminium & Stainless-steel	
Mounting system	Screw fixation	
Pan and tilt wall-mount	60°45° (HxV)	
Finished colour	White (RAL 9016) / Black (RAL 9005)	
Dimensions (WxHxD)	50 x 90 x 65 mm / 1.97 x 3.54 x 2.56 in.	
Weight	0.23 Kg / 0,51 lb	
Pieces per box	1	
Shipping dimensions (WxH)	180 x 140 / 7.1 x 1.57 in.	
Shipping weight	0.25 Kg / 0.55 lb	

PAN & TILT ORIENTATION

1

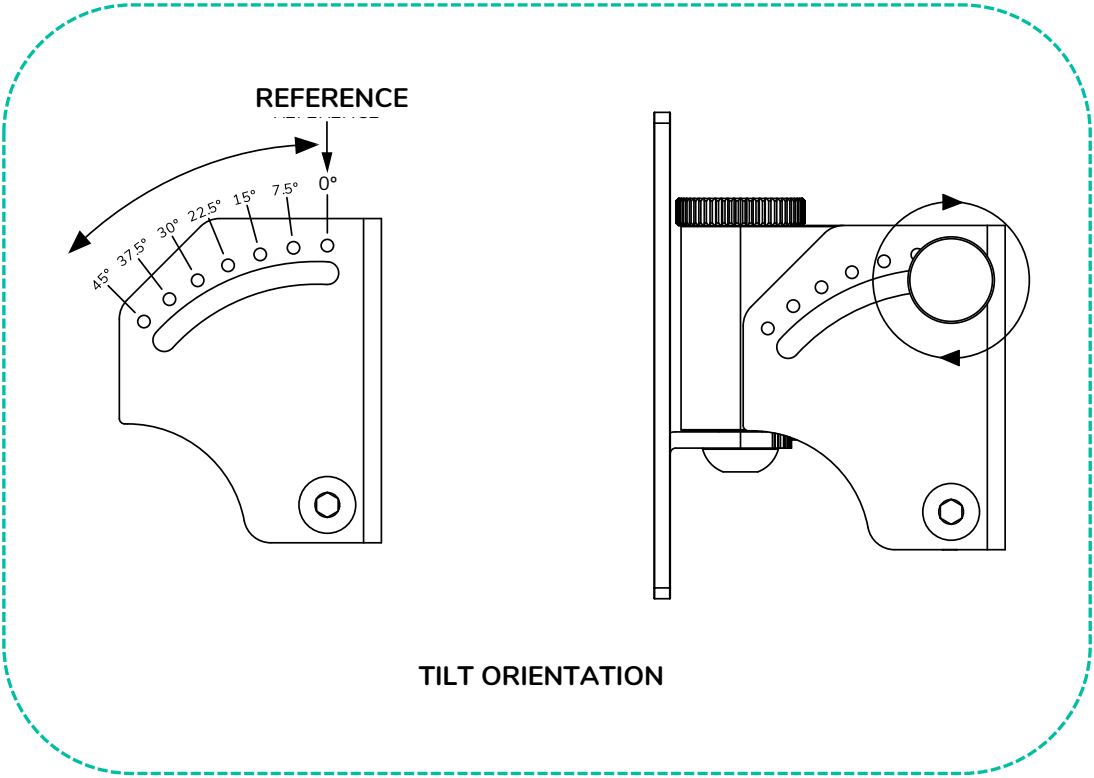

2

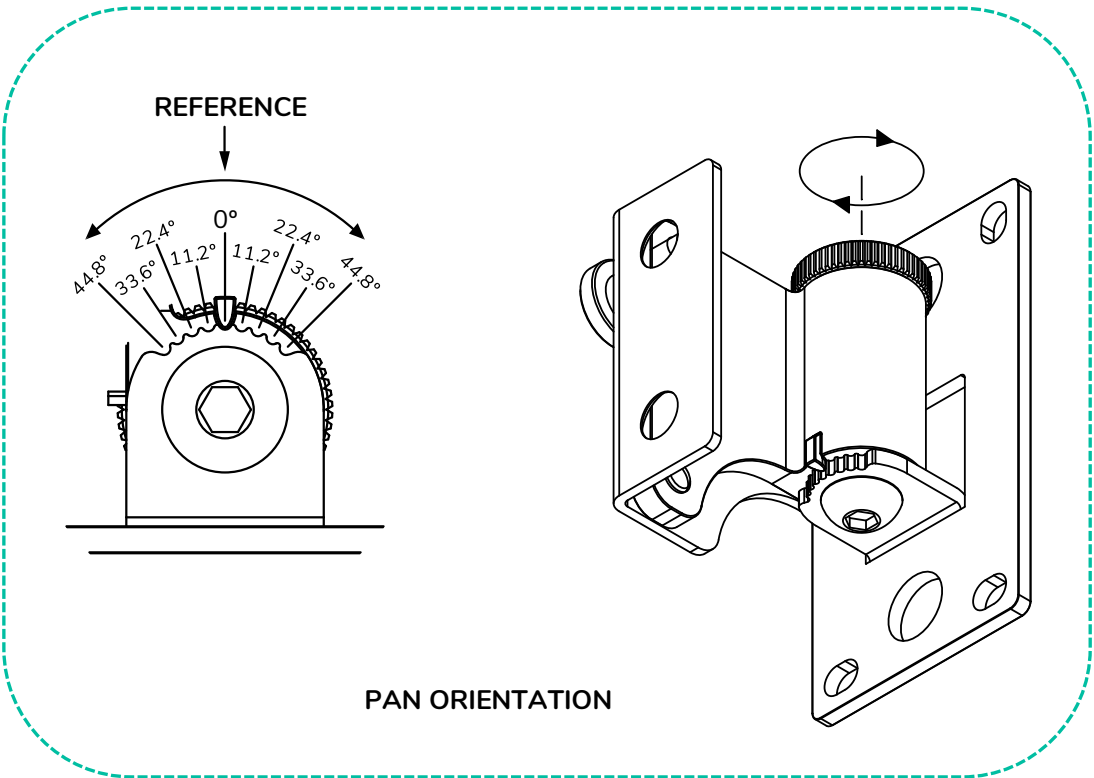

INSTALLATION DIAGRAM

- MIA Series

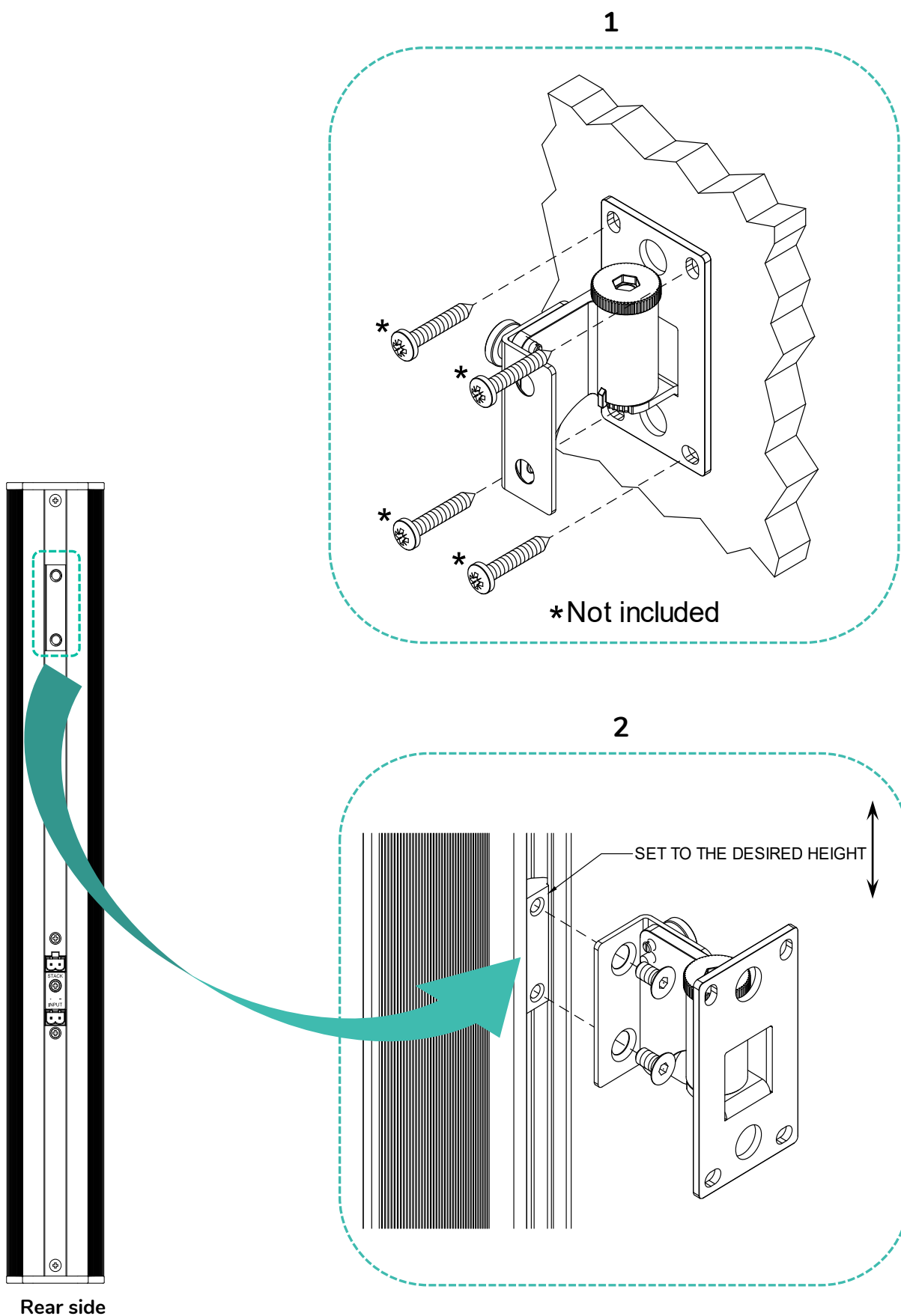

• NIMBO-14

1

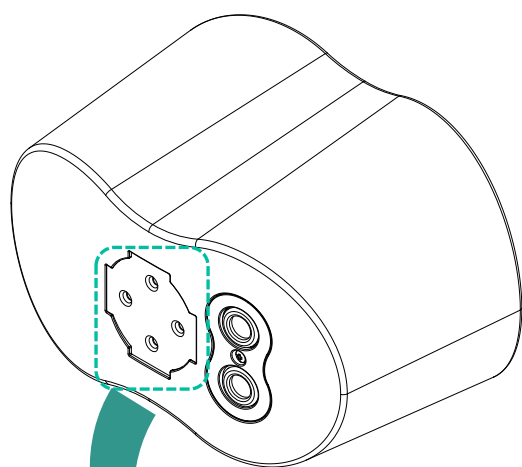
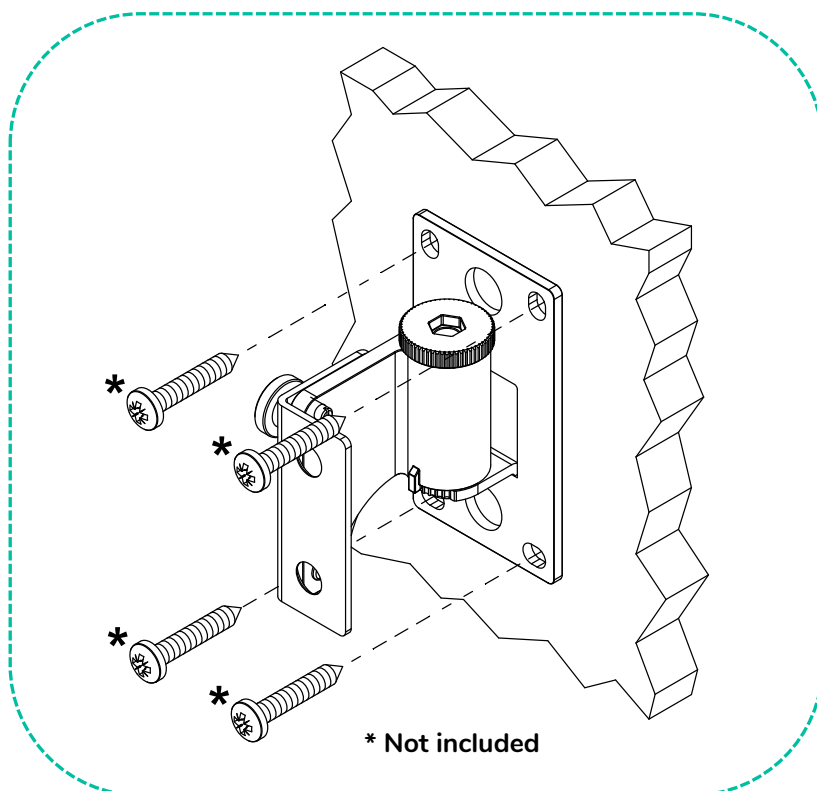

Rear side

2

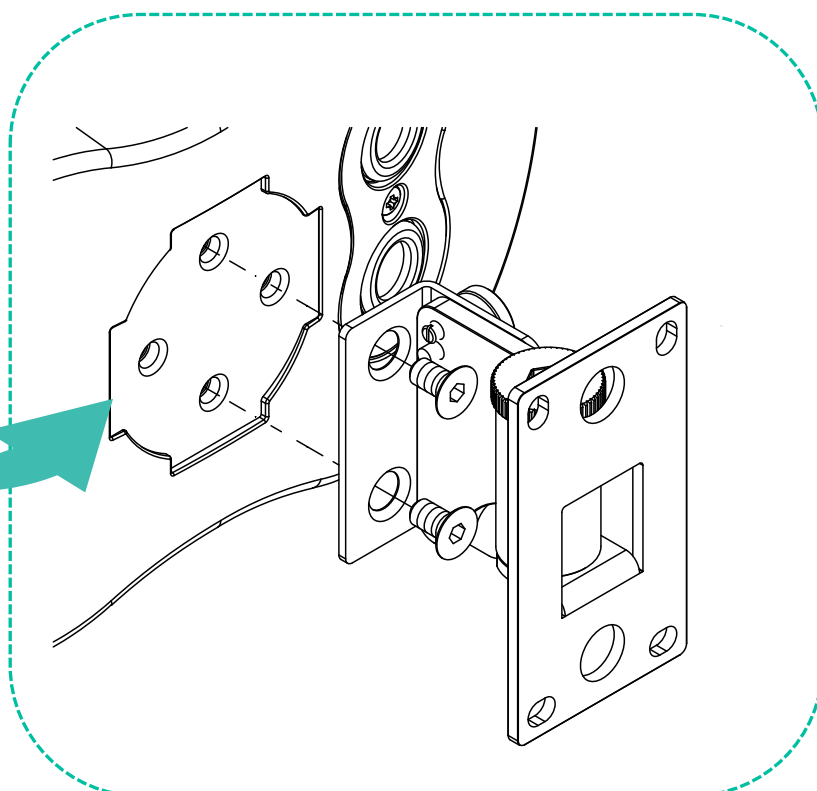

MECHANICAL DIAGRAM



Ecler HANDY Mechanical Diagram

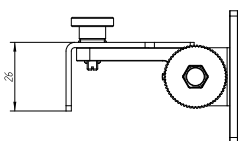
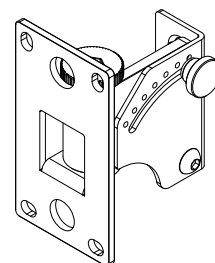
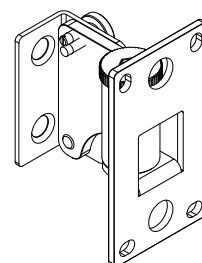
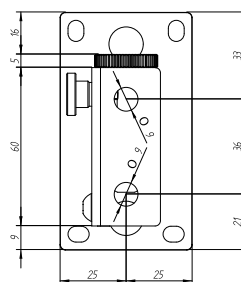
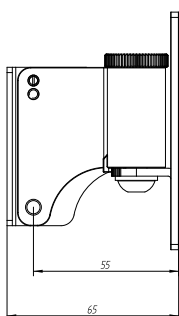
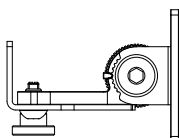
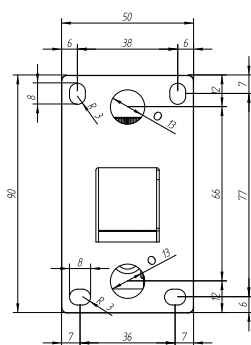

61-1145-0100

www.ecler.com



All product characteristics are subject to variation due to production tolerances. NEEC AUDIO BARCELONA S.L. reserves the right to make changes or improvements in the design or manufacturing that may affect these product specifications.

For technical queries contact your supplier, distributor or complete the contact form on our website, in [Support / Technical requests](#).

Motors, 166-168 - 08038 Barcelona - Spain | Tel. (+34) 932238403 | information@ecler.com | www.ecler.com