

MPAGE4

PAGING STATIONS

Desktop Paging Station



PRODUCT OVERVIEW

MPAGE4 is a 4-zone desktop paging station compatible with Ecler DAM614. It allows for real-time paging with zones' destination in selection.

KEY FEATURES

- 4 zone selection keys
- SELECT ALL, and PAGE keys
- Selectable chime melody
- Gooseneck microphone

APPLICATIONS

- Paging, voice messages and speech

MECHANICAL DIAGRAMS

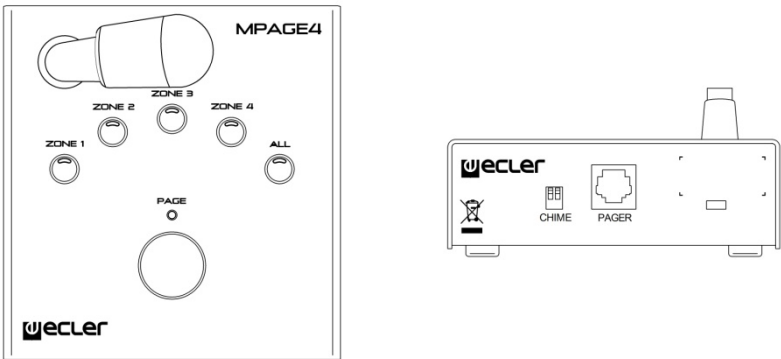

TECHNICAL DATA

Microphone type	Non-removable gooseneck condenser microphone
Polar pattern	Cardioid
Microphone frequency response	50Hz – 18KHz (-10dB)
Output level	0dBV @ 104dB SPL ±7dB (internal adj.)
Chime	DIP selector for mode 1, 2 or 3 or none
Maximum audio cable length	Twisted pair 20m, Shielded 80m (provided that minimum voltage is assured)
Number of paging zones	4
Indicators	Selection LED on all keys
Power supply	+6 to 15V
Connector	RJ45
Maximum power consumption	40mA
Dimensions (microphone excluded)	W 120mm x D 126mm x H 43mm
Weight	625 g
Included accessories	Windscreen